

CASE STUDY BY POPPIN

Managed by Q

MANAGED BY Q

Managed by Q is the platform for office management. Q saves companies time by providing recurring and ad-hoc office services, from evening cleaning to IT support. Today, Q connects thousands of businesses across New York, San Francisco, Los Angeles, and Chicago to the services needed to seamlessly manage their workspace.

AT A GLANCE

Employees: 145

Location: SoHo, New York City

Industry: Internet, Office Services

Products: Series A Double Desks, Max Task Chairs, Pitch Rolling Chairs, Upbeat Stools, Stow File Cabinets

DESIGN CHALLENGE

Managed by Q moved to a new office and needed an open, collaborative workspace. They wanted a clean and polished look that reflects their brand and also gets employees excited to come to work.

THE GOAL

- Create a layout that accommodates different working styles
- Represent the brand with a clean, polished look
- Make employees feel at home with a comfortable workspace

THE SOLUTION

- Series A Desk System with Max Task Chairs and Stow File Cabinets
- Breakout spaces for collaboration equipped with Charcoal Upbeat Stools
- Simple + neutral color palette



poppin.

work happy.

FLAGSHIP SHOWROOM
1115 Broadway, 3rd Floor
New York, NY 10010

For other showroom
locations visit:
poppin.com/showrooms

(888) 676 - 7746
sales@poppin.com
[#poppin #workhappy](https://www.instagram.com/poppin)

©Poppin 2017

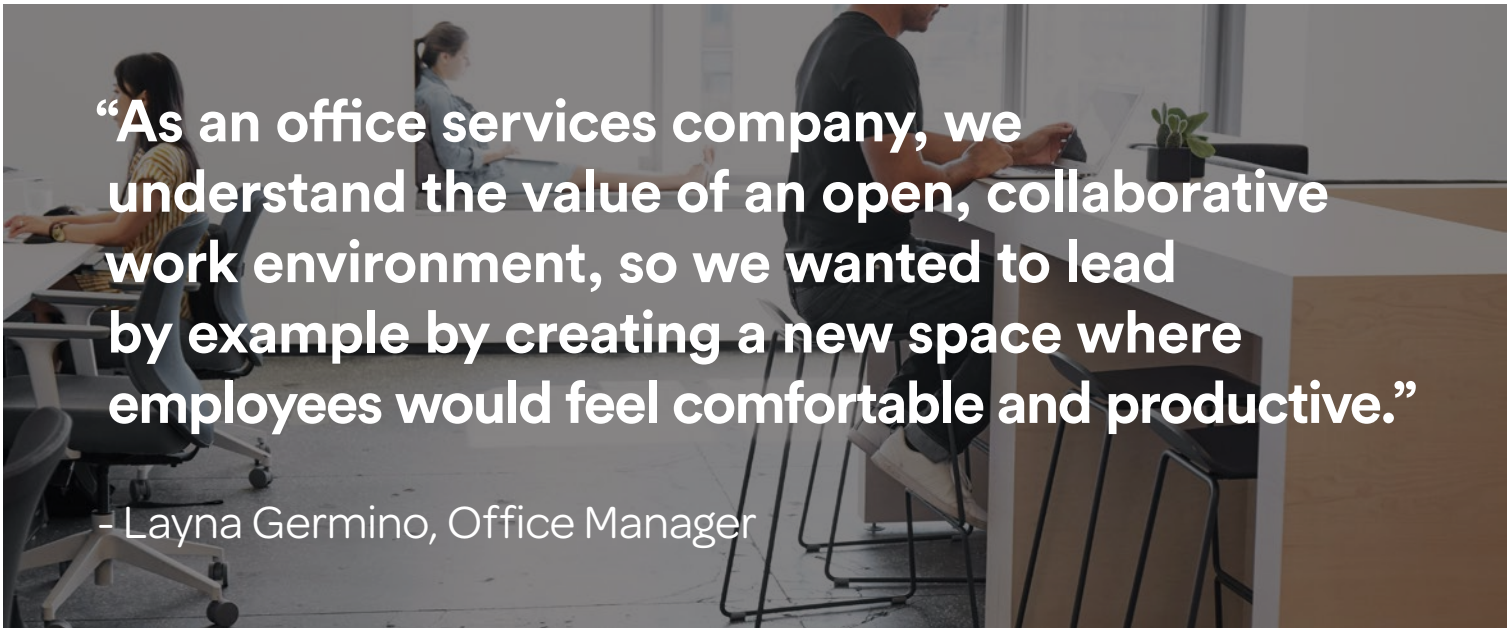

“As an office services company, we understand the value of an open, collaborative work environment, so we wanted to lead by example by creating a new space where employees would feel comfortable and productive.”

- Layna Germino, Office Manager



MIX + MATCH

We helped customize the space by combining White Series A Desks with Dark Gray Max Task Chairs and Black Stow File Cabinets for a clean, high-contrast look that complements the modern office and reflects their brand.

Rows of open Series A Desks allow for office-wide communication and collaboration.

COME TOGETHER

Managed by Q values a creative and collaborative office environment, so we designed breakout spaces to encourage team brainstorms or informal meetings.

Standing Tables and Upbeat Stools work double-duty as an ergonomic standing zone and lunchtime seating.





Khaki Pitch Rolling Chairs carry the clean, neutral palette throughout the office for a cohesive look.

MAXIMIZE SPACE

By creating separate work zones throughout the office, Managed by Q has several designated workspaces for private work, collaborative thinking, and formal meetings.



FLOORPLAN

We work directly with brands to create a custom concept based on the project's unique needs.

POPPIN TIP

To make a clean black and white palette feel modern and inviting, try incorporating additional furniture and accessories in neutral hues with varying textures for added warmth and dimension.

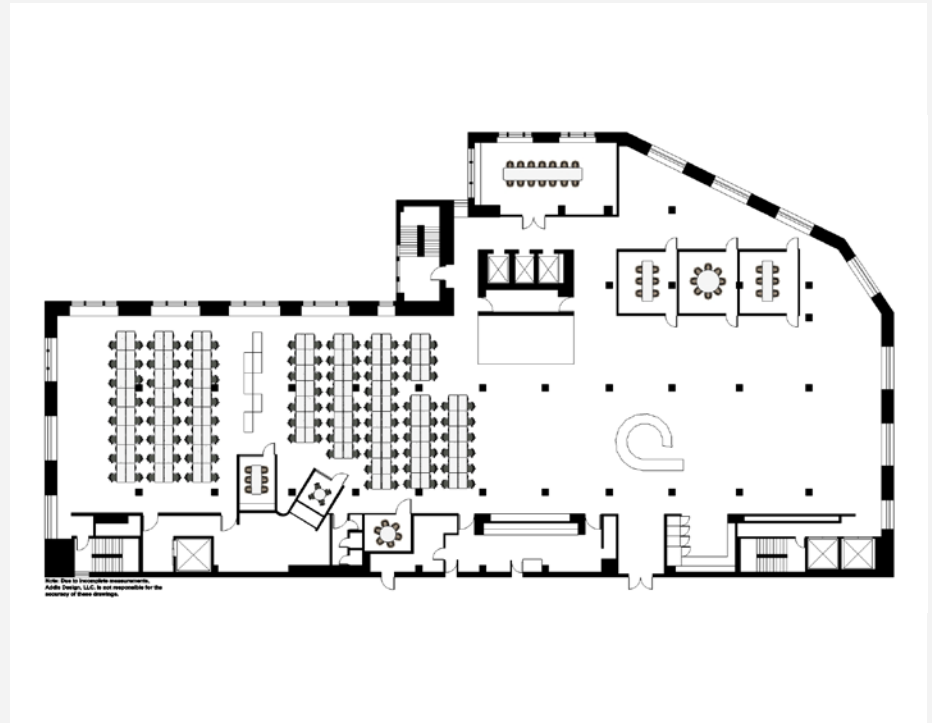

SHOP THE SOLUTION

See how the Poppin Furniture Collection can work for you.



Stow File Cabinet



Series A
Double Desk



Max Task Chair



Pitch Rolling Chair



Upbeat Stool