

the high rise

# Peak Adjustable Height Desk Riser

## ASSEMBLY INSTRUCTIONS

Dreamt up by Poppin in NYC

BELLS + WHISTLES



### HEADS UP!

Squeeze both handles tightly to move the surface up and down.



**TOOL NEEDED!**  
Phillips head screwdriver

### Included in the box:

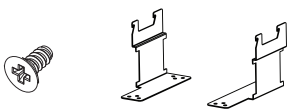

x8 Keyboard Brackets

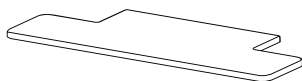

Keyboard Tray

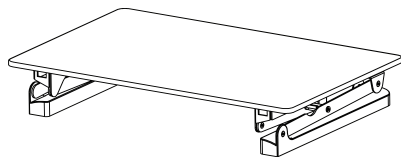

Peak



### WARNING

Ensure all corded items used on the Boost have the cable length required to travel the entire range of motion.

Do not overload the Boost and the keyboard tray. The Boost supports about 30 lbs. The keyboard tray supports about 4 lbs.

### ABOUT POPPIN

Poppin's furniture and office supplies are designed with your success in mind. From a day-brightening Stapler to a game-changing Desk System, Poppin is the one-stop shop for creating inspiring, modern workspaces.

### CARE

Doing a little dirty work? Soak up the spill and then blot with warm water + mild soap.

### 100% WORK HAPPINESS GUARANTEE

For full warranty details, visit [poppin.com](http://poppin.com)

ASSEMBLY

1 Screw the brackets into the keyboard tray

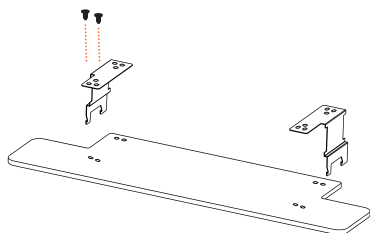

2 Loosen the thumb screws on the Boost frame

3 Hang the keyboard tray brackets off the thumb screws

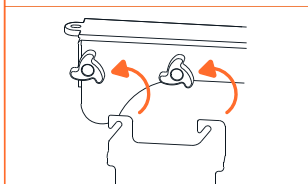

4 Tighten the thumb screws

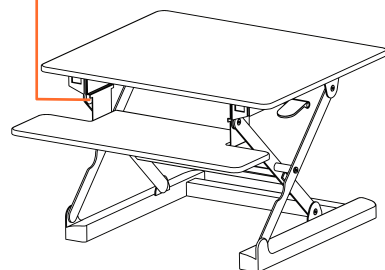

Shop the complete collection at [poppin.com](http://poppin.com)

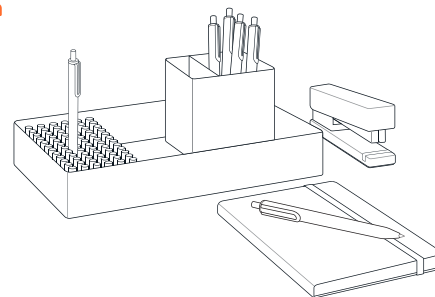

Poppin, Inc.  
New York, NY 10010

(888) 676-7746  
[workstylist@poppin.com](mailto:workstylist@poppin.com)  
[#workhappy\\_poppin](https://twitter.com/workhappy_poppin)